

Instruction manual V1.1_English



SEKURFITTM

 **SEKURIT
service**



1. Before you start

- Please read all instruction carefully
- Retain instructions for future references
- Always place the product on a flat steady and stable surface
- Keep all small parts and packaging material for this product away from babies and children as they potentially pose a serious choking hazard
- Keep using the SEKUFIT™ table for the purposed it was design : manipulation and preparation of automotive glazing before installation on a vehicle
- Max. load to be put on the SEKUFIT™ is 64 kg
- To preserve stability, ensure the glass parts are well placed inside the support polygon formed by the four feet of the SEKUFIT™ table
- Please wear safety gloves to avoid to superficially cut yourself, torn your skin or get your finger caught. Safety gloves with cut-resistant index higher that D are recommended
Same recommendations as above are valid when carrying or manipulating automotive glass products
- Relevant references of safety gloves are available on the Sekurit Service Webshop under:



Sekurit service code	Product description
9207801004	Gloves ANSELL Hyflex® 11-561 - Size 8
9207801006	Gloves ANSELL Hyflex® 11-561 - Size 9
9207801007	Gloves ANSELL Hyflex® 11-561 - Size 10
9207801005	Gloves ANSELL Hyflex® 11-561 - Size 11

SEKURFIT™



2. Main components

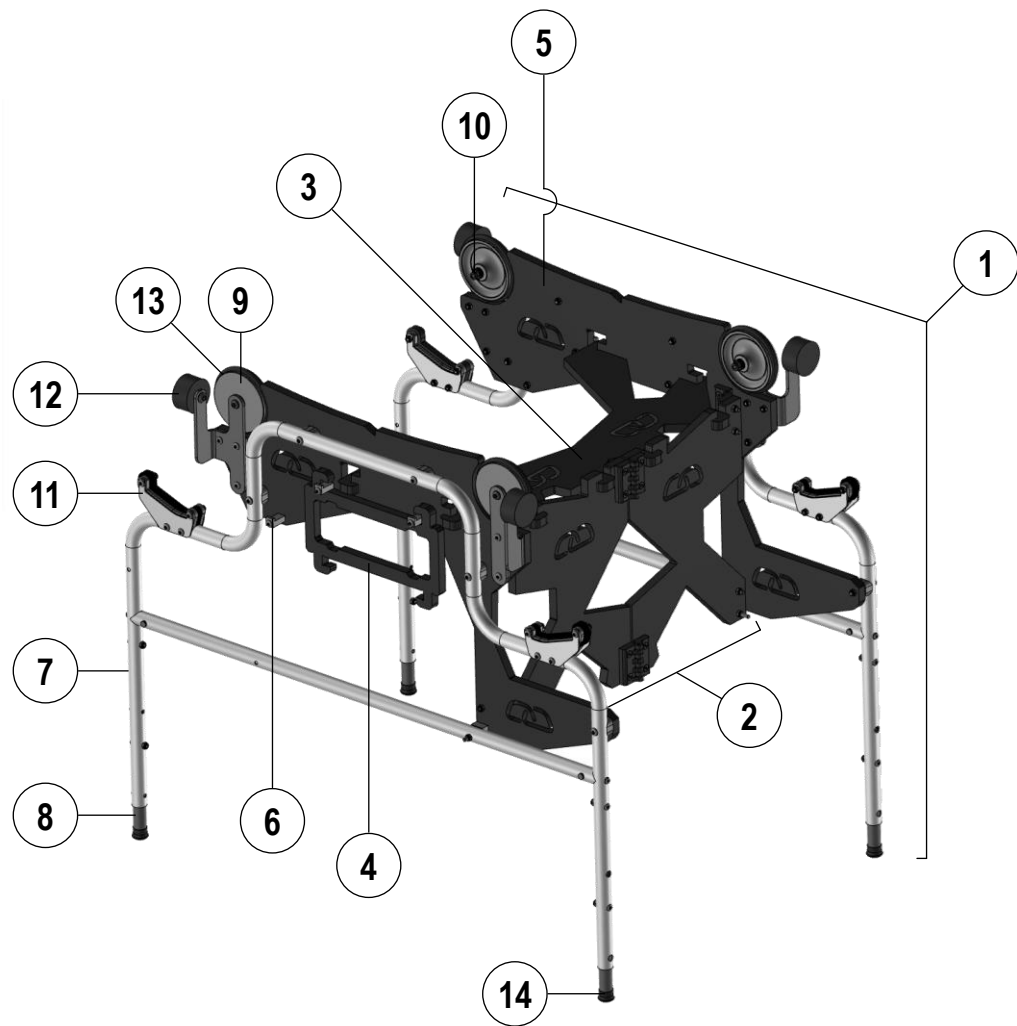

Ref.	Name (English)
①	Lateral frame
②	Central flipping frame
③	Upper plate
④	Locking plate
⑤	Ski
⑥	Hook
⑦	Main tube
⑧	Leg tubes
⑨	Roller
⑩	M8 lock nut
⑪	Glass support
⑫	Glass stopper
⑬	Roller tread
⑭	Rubber end cap

SEKURFIT[®]



3. Mounting instructions

3.1. Unfold SEKURFIT™

- Initial condition : ❶ SEKURFIT™ is on its four feet, in a collapsed state
- Remove the locking plate [4] :
 - Lift-up the **locking plate [4]** to disengage it from the locking slots of the two **skis [5]**
 - ❷ Enlarge place between the **lateral frames [1]** by rotating and enlarging them away
 - ❸ Remove the **locking plate [4]**
 - ❹ Place it on the **hooks [6]** on the external side of the **lateral frame [1]**. Once in place, it will be kept there, directly accessible to the operator

- Place the **upper plate [3]** :
 - ❺ Move the two **lateral frames [1]** away to unfold the **central flipping frame [2]**
 - ❻ Engage the extremities of both sides of the **upper plate [3]** in the locking slots of the two **skis [5]**
 - ❼ Ensure the two right and left **frames [1]** are parallel
 - ❽ Maintain the **central flipping frame [2]** well perpendicular to the **lateral frames [1]**
 - ❾ Punch the **upper plate [3]** firmly downward in the locking slots of the **skis [5]** with your fist

SEKURFIT™ is now unfolded and secured. You can start to use it

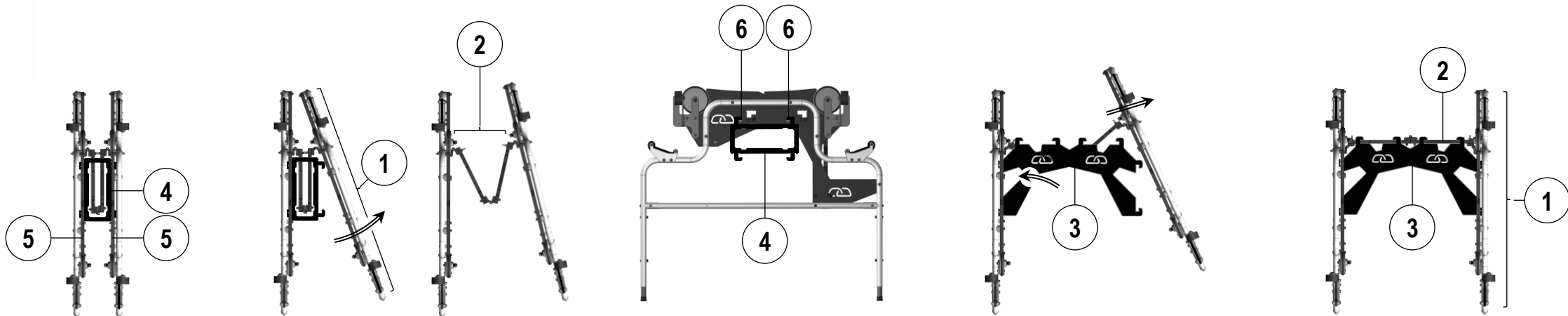

SEKURFIT®

 SEKURIT
service

3. Mounting instructions (following)

3.2. Collapse SEKURFIT™

- Initial condition : ❶ SEKURFIT™ is on its four feet, unfolded and secured by the **upper plate** [3]
- Remove the **upper plate** [3] :
 - Lift-up the **upper plate** [3] to disengage it from the locking slots of the two **lateral frames** [1]
 - ❷ Enlarge place between the **lateral frames** [1] by rotating and enlarging them away
 - ❸ Remove the **upper plate** [3]
 - ❹ Place it on the **hooks** [6] on the external side of the **lateral frame** [1]. Once in place, it will be kept there, directly accessible to the operator ;

- Place the **locking plate** [4] back :
 - ❺ Take the **locking plate** [4] in hand and fold the **central flipping frame** [2] to bring the **lateral frames** [1] closer to each other
 - ❻ Engage the extremities of both sides of the **locking plate** [4] in the locking slots of the **two skis** [5]
 - ❼ Ensure the assembly is well collapsed
 - ❽ Secure the **locking plate** [4] by moving it downwards in the locking slots of the skis

SEKURFIT™ is now folded and secured. You can transport it and/or store it

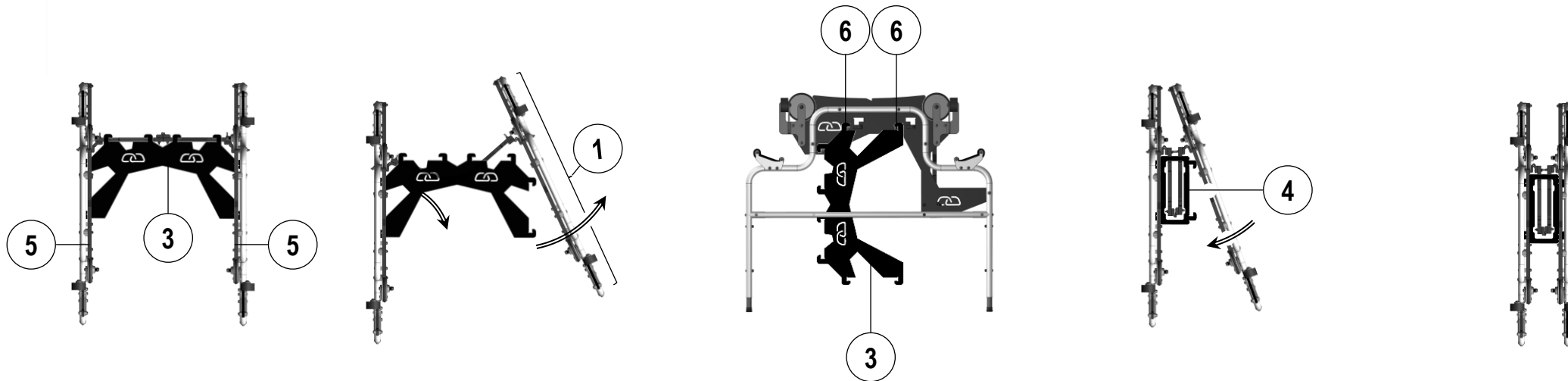

SEKURFIT™

 **SEKURIT**
service

4. Adjustments

4.1. adjusts the height of SEKURFIT™

- A set of four drillings is provided in the main **tube [7]** of SEKURFIT™
- Each is composed of 2 holes of different diameter; the bigger one is designed to receive the head of a screw ;
- Complementary, a set of drilling is provided in the **leg tubes [8]** ;
- Depending on the adjustment, some holes of the main tubes may be occulted by the leg tube ;
- Two screws must be used to secure the height of the table. They should be placed in the two most distant free holes in the main tube. Figure below shows the location of the screws and the corresponding height o the table ;

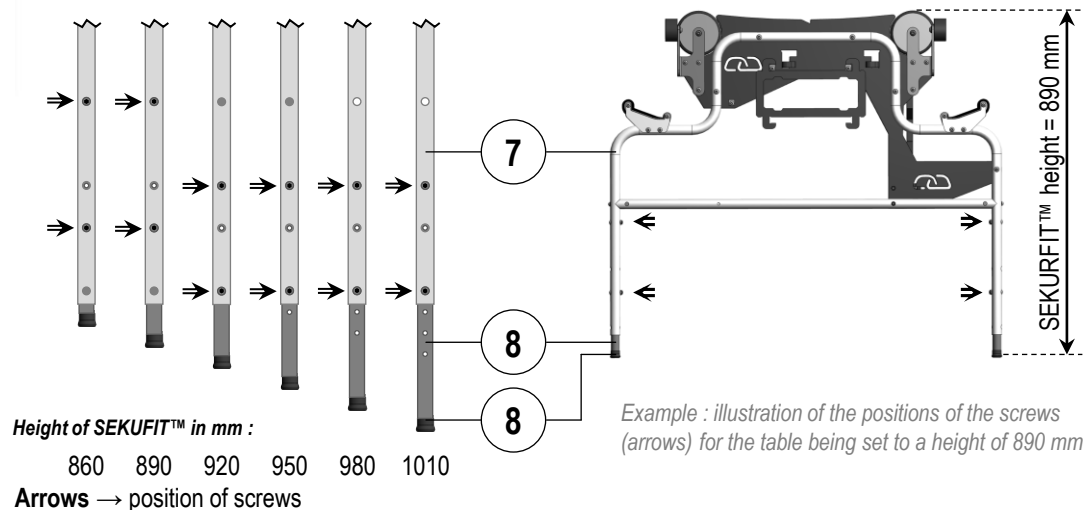

4.2. Adjust the friction of the roller

Friction inside the **rollers [9]** of the SEKURFIT™ should be adjusted to fulfill the following compromise :

- to be high enough to make the glazing stable for preparation operations like cleaning or moving the glass part on the table ;
- to be moderate enough to avoid the fitter to make unnecessary efforts during its preparation ;
- Use the **M8 locknut [10]** on the axis of each roller to adjust its friction ;
- Rotate the **locknut [10]** slowly, typically by a 1/16 rotation, while at the same time testing the resistive torque with the other hand forcing the rotation of the **roller [9]** ;

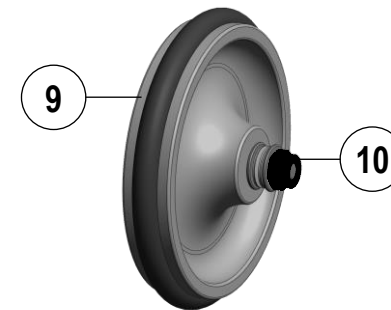

SEKURFIT™

SEKURIT
service

INSPECTION OF THE WINDSCREEN

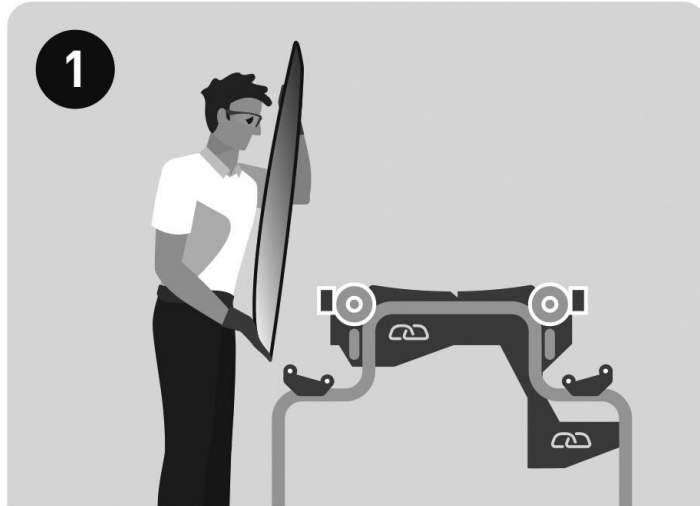

1 Approach the fitting table holding the windscreen close to the body.

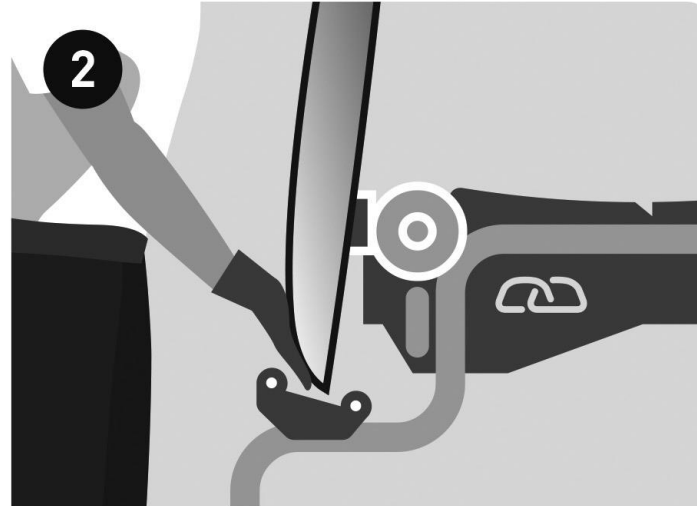

2 Place the windshield in the middle of the rubber pad.

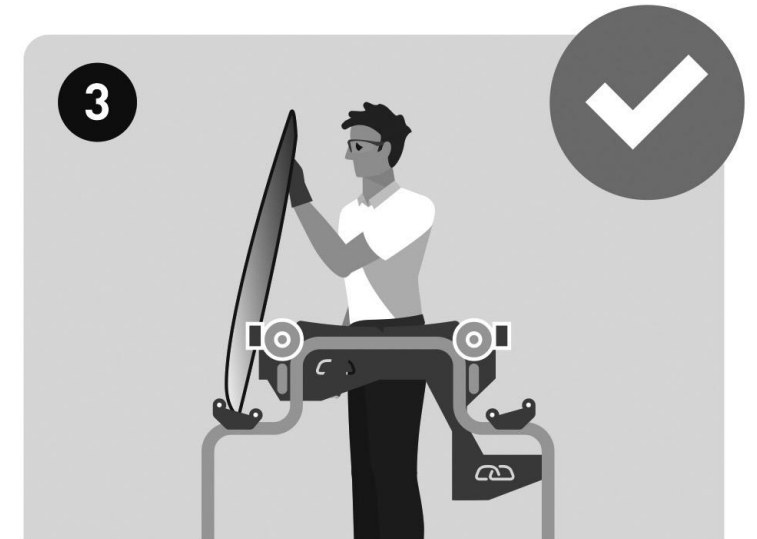

3 Windscreen is now in an ideal vertical position to inspect.

INSTALLATION OF THE WINDSCREEN



Pull the windscreen over the rubber pad in a circular movement.

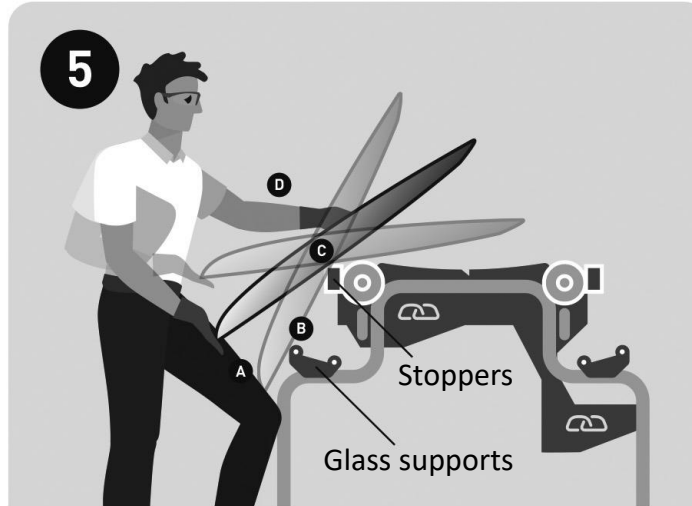

- A. Apply the windscreen against your leg.
- B. Windscreen pressed against glass supports.
- C. Windscreen pressed against stoppers.
- D. Remove upper arm.



- E. Control descent of windscreen with both hands.
- F. Push slowly with both hands on the windscreen to roll it fully horizontal.

INSTALLATION OF THE WINDSCREEN

7

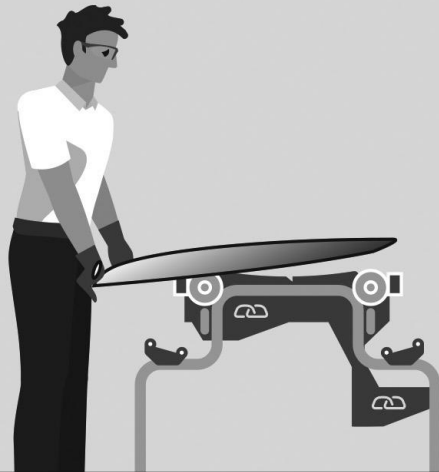

Sometimes the windscreen is equipped with a rubber trim on top.
In that case push your two hands down on windscreen.

8

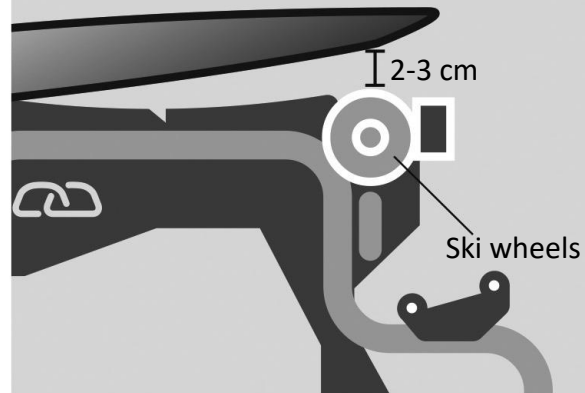

Maintain a 2-3 cm gap between upper part of the windscreen and ski wheels.

9

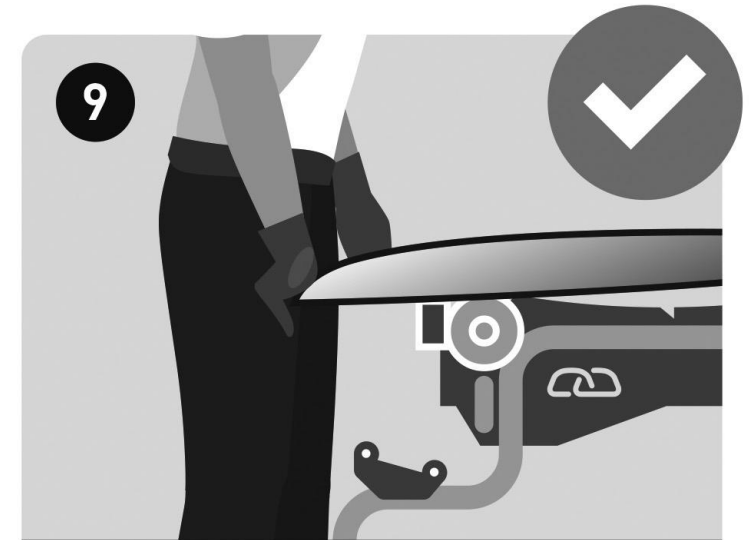

Push the windscreen to the stable endpoint with the help of your body.

FLIPPING THE WINDSCREEN

10

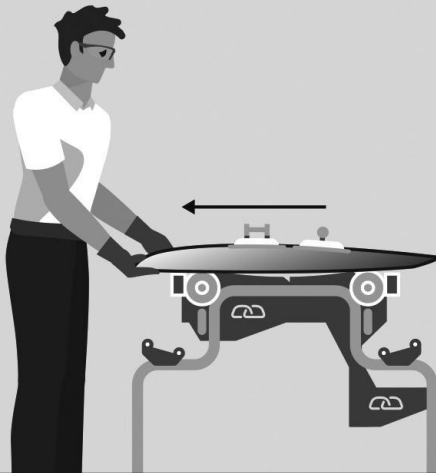

Pull the windscreen backwards.

11

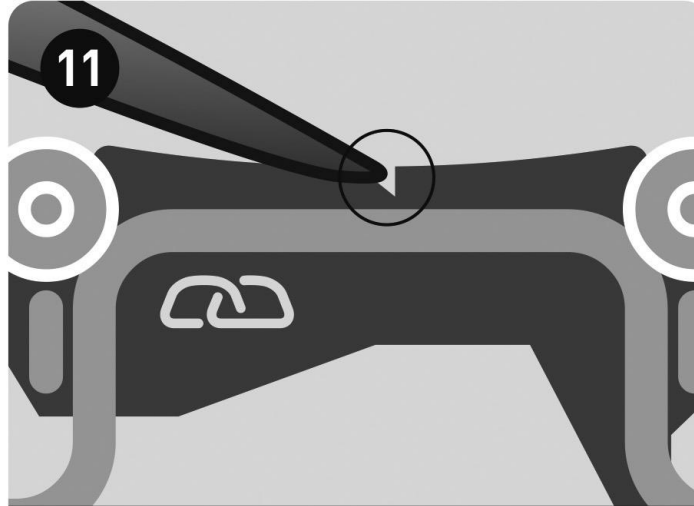

Secure the windscreen into the notches before raising.

12

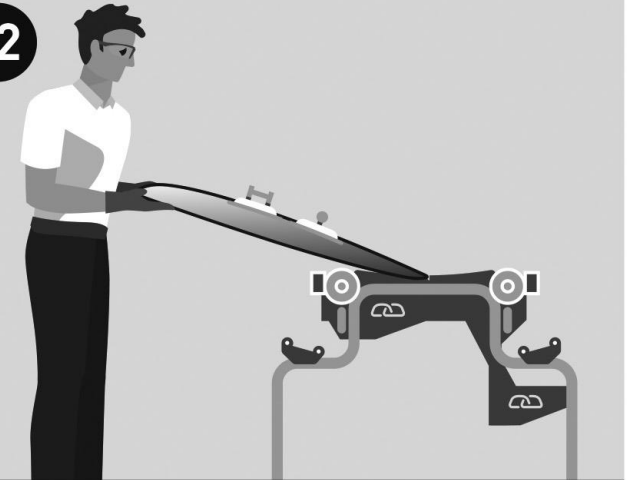

Raise the windscreen slowly to a vertical position.

SEKURFIT®

SEKURIT
service

FLIPPING THE WINDSCREEN

13

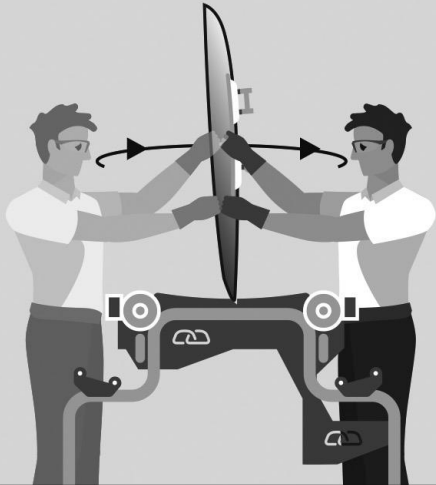

Turn around the table while maintaining the windscreen in a vertical position.

14

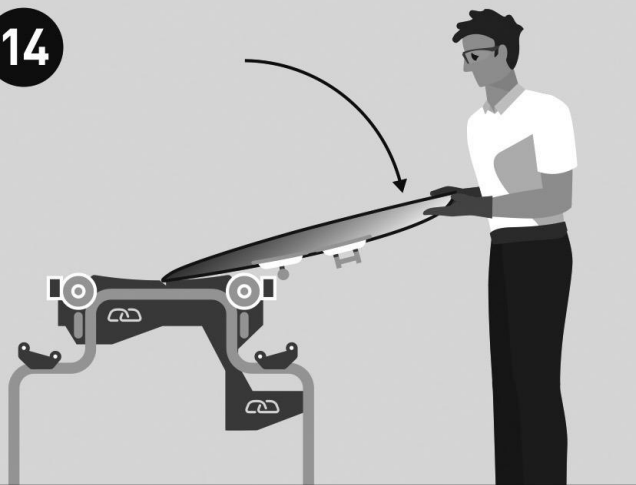

Control the lowering of the windscreen.

15

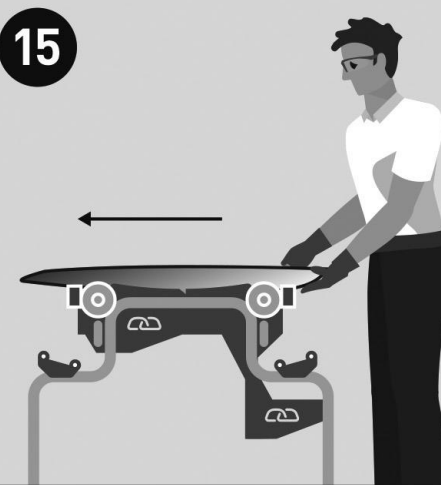

Push it to the centre of the table to your end position.

RAISING THE WINDSCREEN

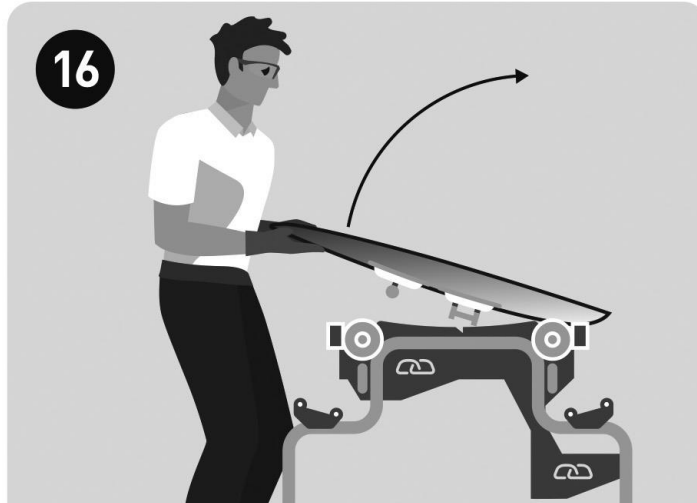

Use your knees (not your back) and start raising the windscreen.

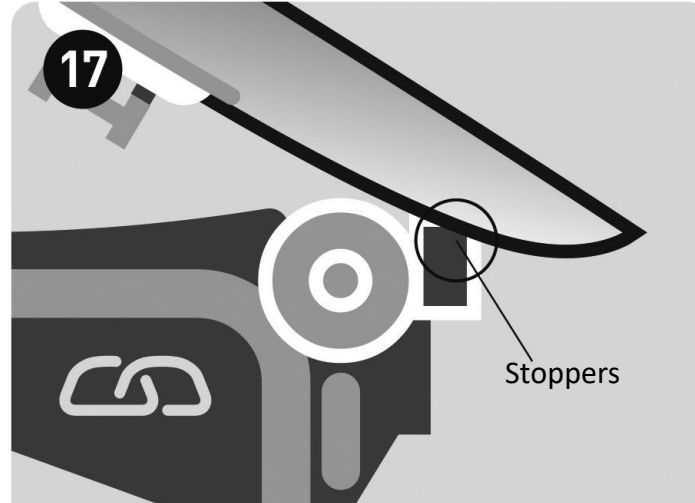

Look at the stoppers, once the surface of the windscreen is contact with them, windscreen is very stable.

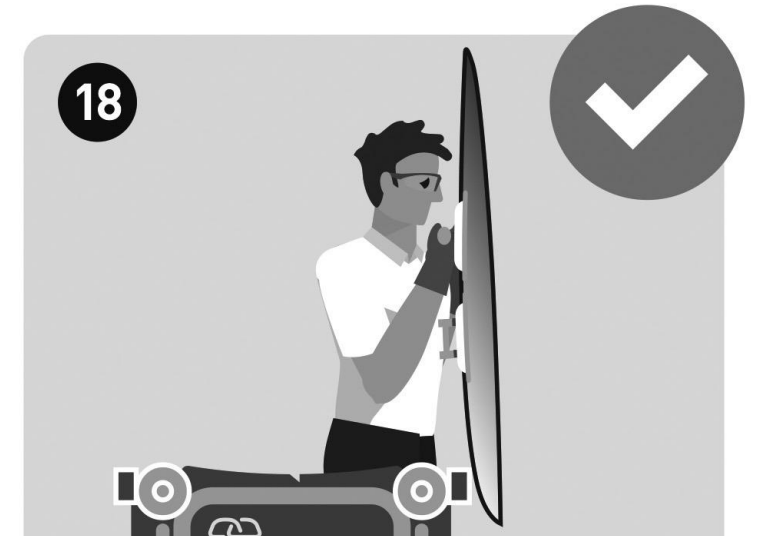

Keep walking until your body touches the upper support of the table. Do not counter bend your back, your face should be as near to the windscreen as possible.

6. Spare parts & after sale service

Picture	Sekurit service code	Product description
	9209300111	SEKURFIT™ Rubber Pad for Glass Support [11]
	9209300112	SEKURFIT™ Rubber Pad for Glass Stopper [12]
	9209300113	SEKURFIT™ Rubber End Cap [14]
	9209302001	SEKURFIT™ Roller tread [13]

6.1. Spare parts

Four spare parts are available directly on the Sekurit Service Webshop. There are all composed of high grip rubber and are designed to be in contact with the glass. The table below list them as well as their references.

6.2. After sale service

Spare parts above are considered as consumable. For any issue with any other part, Sekurit Service will maintain the main components of the table accessible at least up to year 2029. Please contact your local Sekurit Service sales representative for any question related to after sale service.

7. Maintenance and Cleaning

7.1 Maintenance is minimal :

- do not use lubricant inside the roller axis, this will disturb the adjustment of the friction of the **roller [9]** and may damage the roller itself
- plastic and rubber parts should not be put in contact with solvent, oil or grease. This may damage their mechanical properties as well as their ability to be in contact with glass

7.2 Cleaning :

- SEKUFIT™ is made of high-quality durable material. To get the best out of it for many years, we recommend to protect it with a protective canvas against humidity, rain and dust
- when you need to clean SEKUFIT™ use or a dry soft piece of fabric to remove dust. In case of stain, use a soft fabric impregnated with water and plain soft soap
- in case of contamination with glue, the best is to wait until it harden, then to scrap it gently. Never use a solvent
- rubber parts may from time to time be polluted with dust. To preserve a good grip and to avoid generate scratches on glass, we recommend to remove dust by applying a dry soft piece of fabric. In case, dust is strongly incrustated at the surface of rubber components, you may then use a soft fabric impregnated with water and plain soft soap
- in case the **Glass Stopper [12]** is locally damaged or when its grip power has decreased, you may turn it by a quarter of a turn to renew the surface in contact with glass

8. Warranty

SEKUFIT™ has a two years warranty, under normal conditions of use, excluding rubber-based components that are considered as consumable. Sekurit Service will not cover any loss or damage resulting from non-ordinary use like non respect of the standardized procedure to prepare automotive glazing, overcharge, shocks with other equipment, modifications, inappropriate mechanical adjustments, puncture or cut by glass or knife, dirt deposit, glue deposit, use of oil or solvent, etc., or prolonged exposure to humidity, rain or direct sunlight.

Spare parts are considered as consumable. Unless for **rubber end cap [14]** [Sekurit Service ref. : 9209300113], and given the high quality of the material used for SEKUFIT™ components, these parts are warranted for one year under normal conditions of use, excluding loss or damage resulting from non-ordinary use like non respect of the standardized procedure to prepare automotive glazing, chocks with external equipment or tools, puncture or cut by glass or knife, dirt deposit, glue deposit, use of oil or solvent, etc., or prolonged exposure to humidity, rain or direct sunlight.

The **rubber end cap [14]** part [Sekurit Service ref. : 9209300113], which covers the extremity of the feet that are in contact with the floor of the workshop have no warranty since their durability strongly depends on the conditions of usage and nature of floor. Marks generated by wear of the ferrule material can be produced, depending on the nature of the floor. Sekurit Service disclaim any damage against such marks.